

Serrated Flange Bolt

Bolts from Hill SAE 8.2 R C = 34-42
 Bolts from Mclean 1022 case Hardened R C = 26-34

Plain = HSF010-----

Zinc = HSF010-----Z1

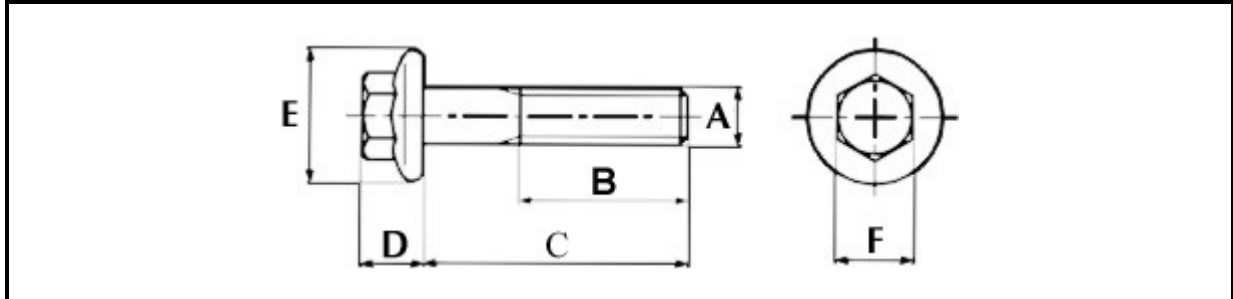

Diameter (A)	Thread Length		Height (D)	Flange Diameter (E)	Width A.F. (F)
	C < 6" (B)	C > 6" (B)			
1/4	0.750"	1.000"	.28"	.56"	3/8"
5/16	0.875"	1.125"	.32"	.68"	1/2"
3/8	1.000"	1.250"	.39"	.81"	9/16"
7/16	1.125"	1.375"	.46"	.93"	5/8"
1/2	1.250"	1.500"	.51"	1.07"	3/4"
9/16	1.375"	1.625"	.57"	1.19"	13/16"
5/8	1.500"	1.750"	.62"	1.33"	15/16"
3/4	1.750"	2.000"	.73"	1.59"	1 1/8"

Note:

Hex Serrated Large Flange Bolts

Plain = HSLF010-----

Zinc = HSLF010-----Z1